

1.0 INTRODUCTION

The landscape architectural practice FORtium Pty Ltd was engaged by Entura Pty Ltd to undertake the landscape design for the Frasers Solar Farm in Glenelg North, Victoria.

2.0 LIST OF DRAWINGS

LC01 - LANDSCAPE CONCEPT
LC02 - LANDSCAPE CONCEPT PLAN
LC03 - LANDSCAPE SECTIONS AND DETAILS
LC04 - PLANTING PHOTOS AND SCHEDULE

3.0 EXISTING SITE CONDITIONS AND CONTEXT

The site is located at the intersection of Traralgon-Trafra Road and Frasers Lane in Glenelg North. A recent aerial photo of the existing site is shown on LC02. The site is currently a grazing livestock farm, with remnant trees, two buildings, seven dams, and windbreak strip fairly recently planted along the Western boundary.

4.0 EXISTING VEGETATION

Existing perimeter trees are identified on the Landscape Plan.

Refer to the Conservation Report for the 'Existing Trees Location Plan'.

Existing remnant trees on the Traralgon-Trafra Road reserve are limited to small copses of *Acacia melanoxylon*, Blackwood, located near the South-eastern corner. Some of these trees occur close to the existing overhead transmission lines, and are lopped where below the power lines.

Existing remnant trees along Frasers Lane frontage include 9 No. *Eucalyptus melliodora*, Yellow Box, and 1 No. *Eucalyptus gonicalyx*, Long Leaved Box.

The existing 'Wind Break' planting strip to the Western boundary contains a mix of hardy native trees and shrubs, including Casuarina, Callistemon, Acacia and Gums. Larger plants are about 3 metres high.

5.0 LANDSCAPE DESIGN INTENT

The landscape design intent is to provide an attractive and consistent landscape perimeter of high quality buffer planting strips, with a strong sense of local rural character. These will effectively and fairly quickly screen and buffer the view of the solar farm - a traditional farm windbreak character. The Landscape Concept Plan is shown on LC02, with supporting illustrative Sections and Details on LC03 and Plant Schedule and Images on LC04.

The landscape treatment includes:

- Windbreak tree planting, using three rows of mixed indigenous plant species suitable for long term visual screening of the solar farm from adjacent roads and farms, while providing wind protection amenity to the Solar farm from the surrounding open plains.
- Security woven-wire mesh fence (2.1 metres height) along road reserve boundaries, and along Western and Southern boundaries.
- Wire mesh vehicle access gates are located midway along the Traralgon-Trafra Road frontage, and two others spaced equally along Frasers Lane frontage.
- Retention of existing established trees along Frasers Lane frontage. These existing trees include 9 No. *Eucalyptus melliodora*, Yellow Box, and 1 No. *Eucalyptus gonicalyx*, Long Leaved Box.
- Retention and infill planting of the existing 'Shelter Belt' planting strip to the Western and partial Southern boundary.
- Retention of existing, and infill planting of the indigenous *Eucalyptus camaldulensis*, River Red Gums to the South-West corner.

6.0 PLANTING SPECIES

The proposed planting species are listed in the Plant Schedule and photos of the main plant theme species are shown in the Plant Theme Photos on drawing LC04.

The plant species have been selected because they are attractive, hardy species, of low water demand, which are suitable in a relatively harsh rural environment. They are local indigenous species, and are suited to the local Gippsland growing conditions. The proposed planting species have been divided into three classifications Dominant Trees, Understorey Trees and Large Shrubs that will combine to establish a continuous vegetation buffer approximately 1 to 10 metres in height at maturity (25 years), to the entire site perimeter.

Dominant trees to include:

- *Eucalyptus camaldulensis*, River Red Gum
- *Eucalyptus viminalis*, Manna Gum
- *Eucalyptus melliodora*, Yellow Box
- *Eucalyptus ovata*, Swamp Gum

All trees will be supplied, and planted using 100mm pot size stock, while the balance of planting to be supplied as tubestock. All planting is to occur with tree guard as shown in the planting details.

All indigenous plants are to be of local provenance, and supplied by a local indigenous plant nursery.

REVISION	DATE	SCALE	NTS @ A0
C	OCT 2019	DATE	OCT 2019
PLANNING ISSUE	JOB NO.		2066

PROJECT: FRASERS SOLAR FARM

DRAWING
LANDSCAPE CONCEPT



South Energy
South Energy
Level 20
Medicine Hat
Melbourne VIC 3000
Ph: +61 (03) 8842 6888
www.southenergy.com.au

entura The power of natural thinking
80 Cambridge Park Drive
Cambridge, Tasmania, 7170, AUSTRALIA
Ph: 03 6245 4500 Fax: 03 6245 4550
www.entura.com.au

DRAWING NO.
LC 01

REV C

Fraser's Solar Farm LANDSCAPE CONCEPT

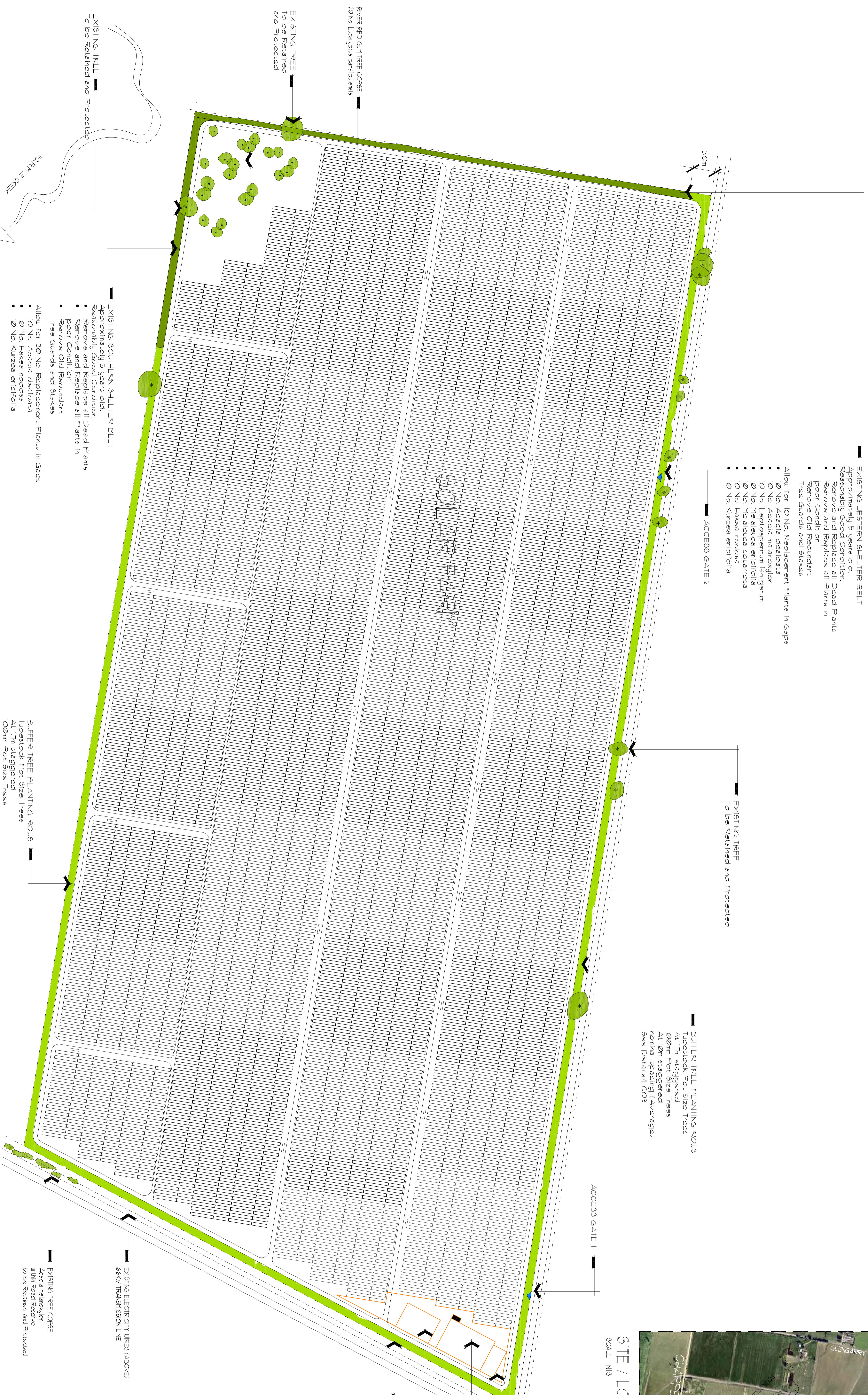

SITE / LOCATION PLAN
 SCALE NTS

- SWITCHING YARD
Refer to Architect's Drawing
- SUBSTATION AND 0.4M BUILDING
Refer to Architect's Drawing
- BESS Refer to Architect's Drawing
- BUFFER TREE PLANTING ROUS
Tubestock Pot Size Trees
At 1.1m staggered
100mm Pot Size Trees
At 10m staggered
nominal spacing (Averages)
See Section AA and
Detail Plan LC03
- EXISTING TREE TO BE RETAINED AND PROTECTED
- PROPOSED ISOLATED TREES
Eucalyptus camaldulensis
River Red Gum
Planted in Coppases
- 10m WIDE BUFFER TREE PLANTING ROUS
See Detail Plan / LC 03A and LC 03B
- 10m WIDE EXISTING SHELTER BELT
Approximately 5 years old
Reasonable Condition
Remove and Replace all Dead Plants
Remove and Replace all Plants in
poor Condition
Remove Old Plant Covers and Stakes

KEY

EXISTING VEGETATION
 Refer to Arborist Report for Existing Vegetation Plan and List

BUFFER PLANTING DENSITY & SPECIES MIX
 Refer to Plant Schedule for Species Planting Mix Ratio

NOTES:

EXISTING VEGETATION
 Refer to Arborist Report for Existing Vegetation Plan and List

BUFFER PLANTING DENSITY & SPECIES MIX
 Refer to Plant Schedule for Species Planting Mix Ratio

LANDSCAPE CONCEPT PLAN 1 : 1000 @ A0

REVISION	DATE	SCALE
C	OCT 2019	1:2000 @ A0
PLANNING 1591E	OCT 2019	OCT 2019
		JOB NO. 2066

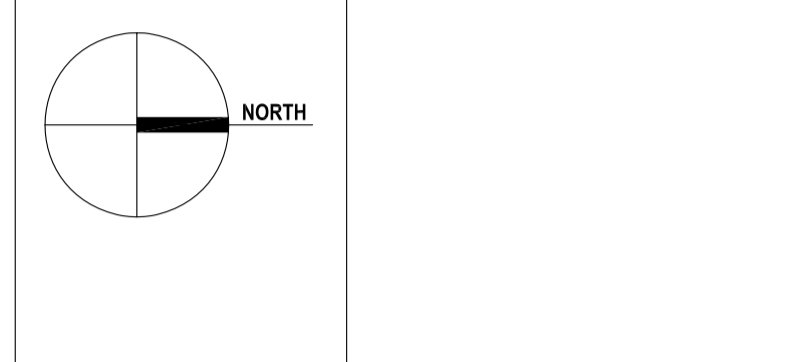

PROJECT
 FRASERS SOLAR FARM

DRAWING
 LANDSCAPE CONCEPT PLAN



South Energy
 South Energy
 Level 2
 Melbourne VIC 3000
 Ph: +61 (03) 8942 8888
 www.southenergy.com.au

entura
 The power of
 natural thinking
 89 Cambridge Park Drive,
 Camberidge, Tasmalia 7170 AUSTRALIA
 Ph: 03 6245 4500 Fax: 03 6245 4550
 www.entura.com.au

DRAWING NO.
 LC 02

REV C

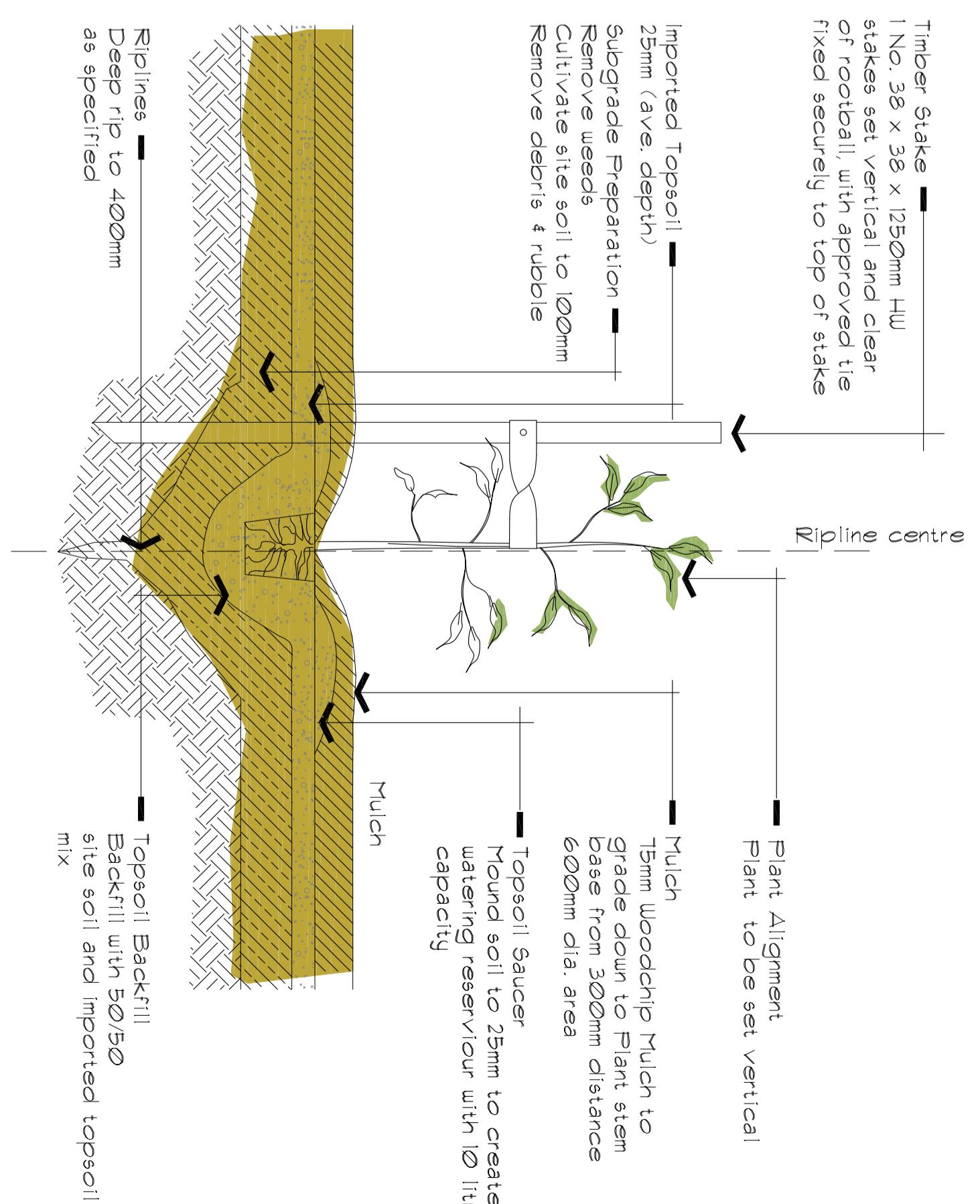
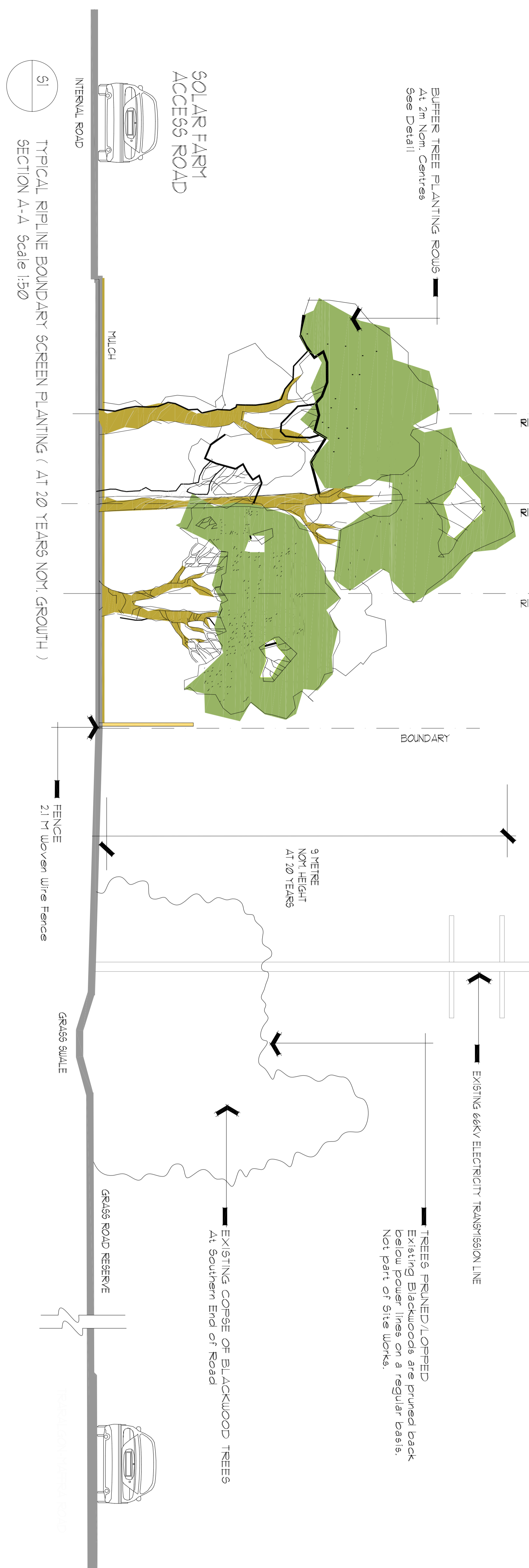
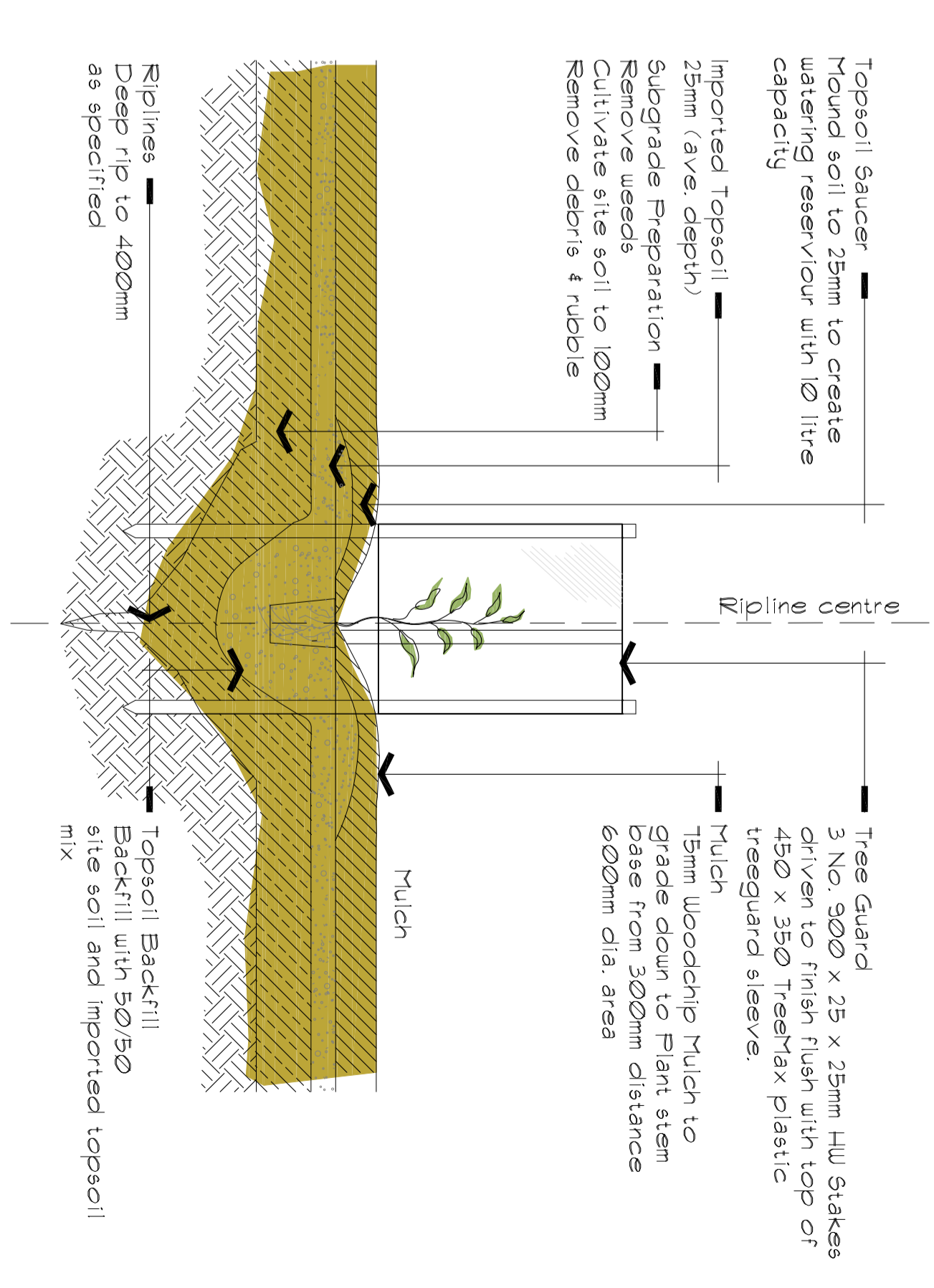
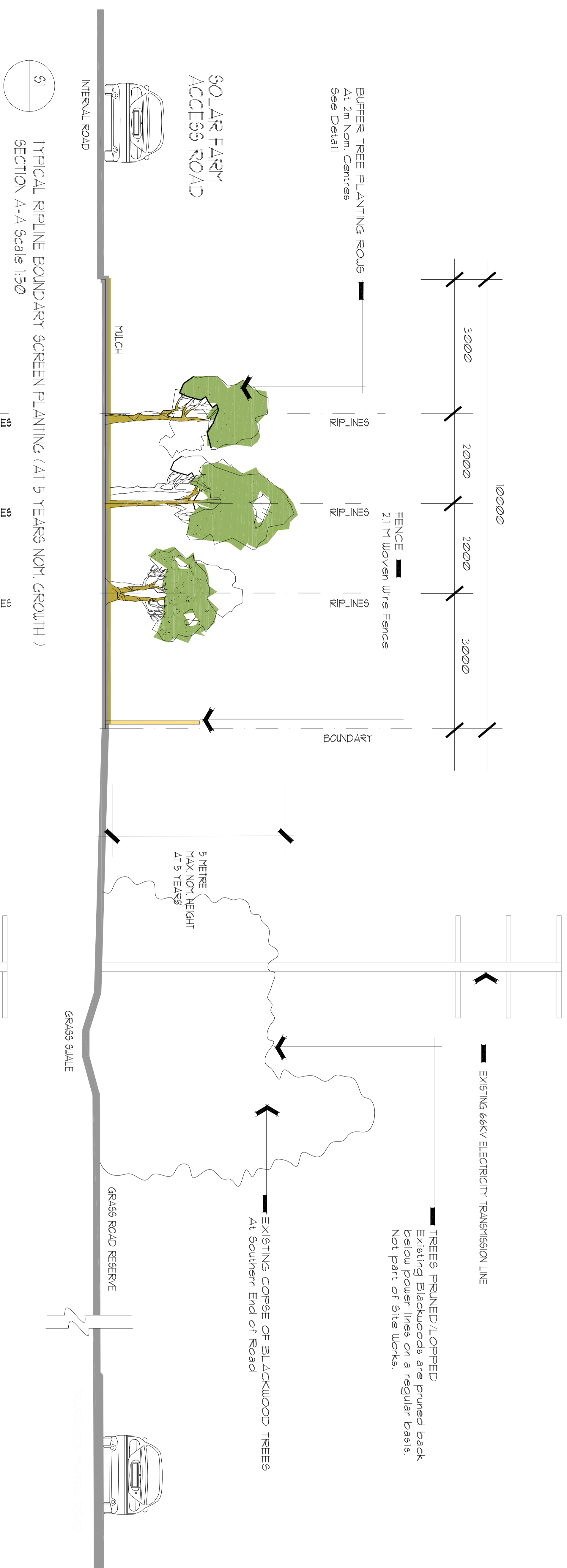

D1 TYPICAL BUFFER RIPLINE PLANTING
DETAIL PLAN Scale 1:50

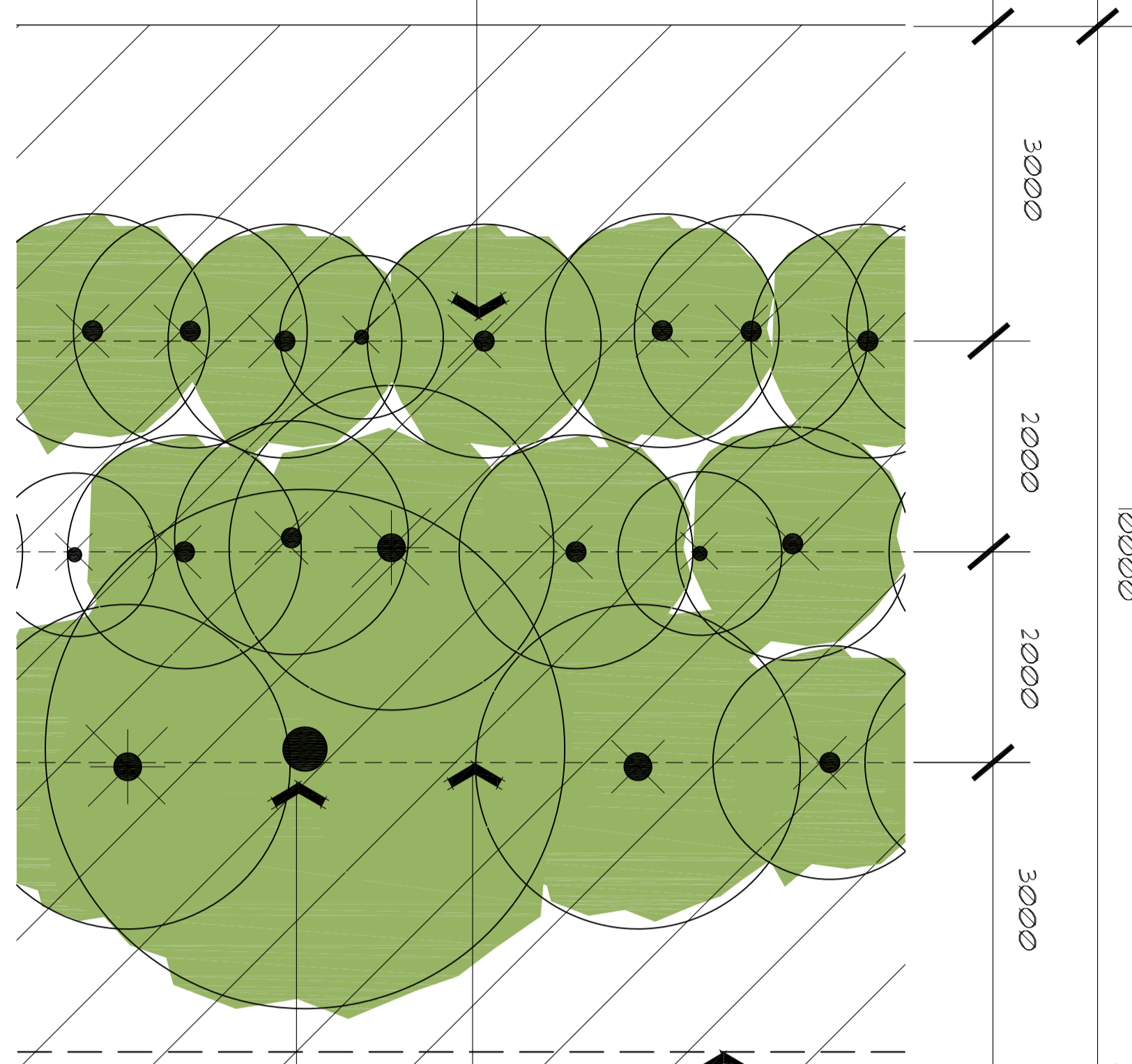

DOMINANT TREES



Eucalyptus melliodora Yellow Box

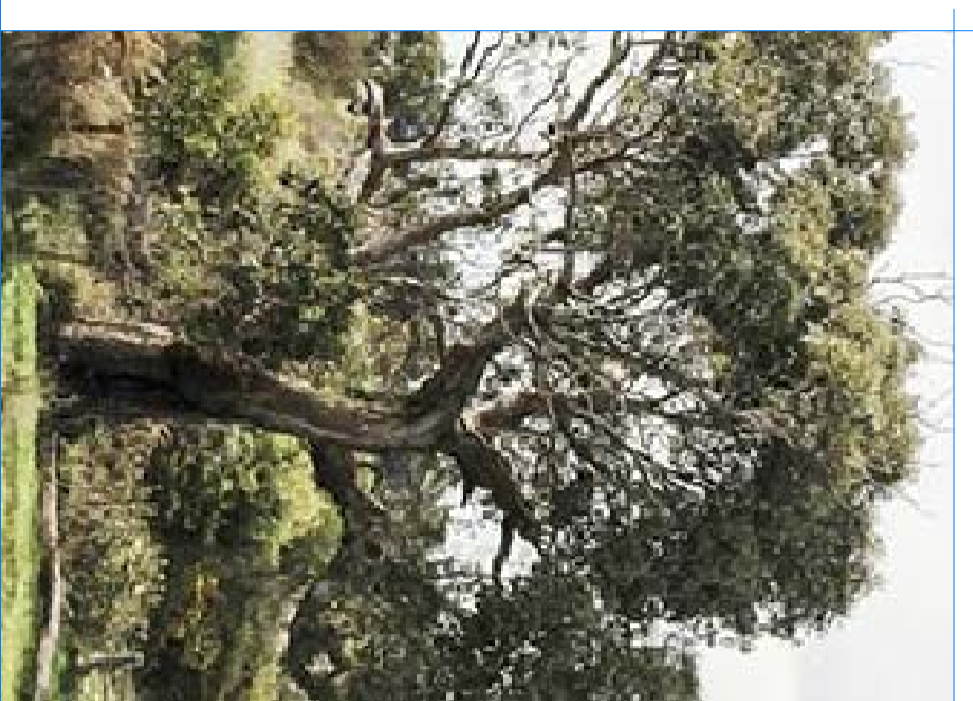

Eucalyptus ovata Swamp Gum

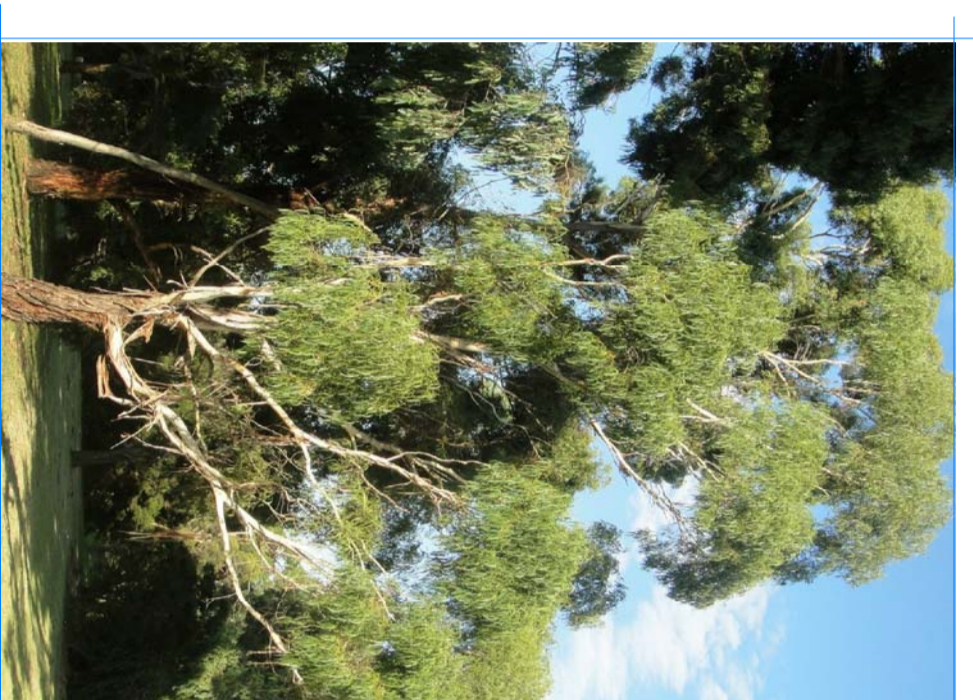

Eucalyptus viminalis Tanna Gum

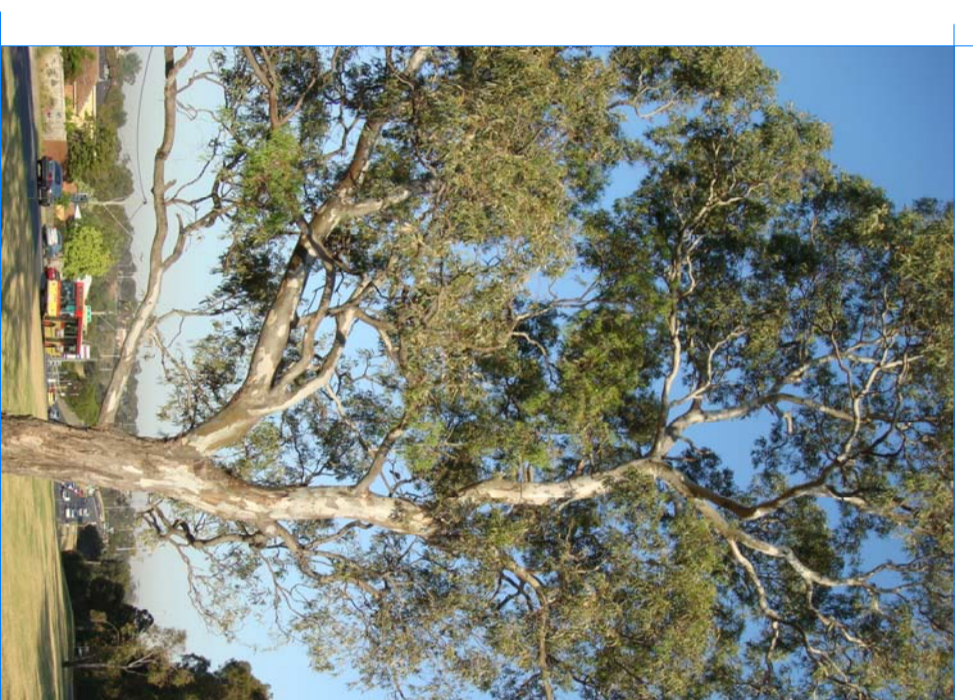

Eucalyptus camaldulensis River Red Gum

PLANT SCHEDULE

BOTANICAL NAME	COMMON NAME	MIX RATIO	SUPPLY SIZE	APPROX MATURE SIZE (HxW) (25 yrs)
DOMINANT TREES				
<i>Eucalyptus camaldulensis</i>	River Red Gum	3 %	100mm pot size	10 x 6m
<i>Eucalyptus melliodora</i>	Yellow Box	3 %	100mm pot size	9 x 5m
<i>Eucalyptus ovata</i>	Swamp Gum	2 %	100mm pot size	6 x 5m
<i>Eucalyptus viminalis</i>	Tanna Gum	2 %	100mm pot size	9 x 6m

UNDERSTOREY TREES

<i>Acacia dealbata</i>	Silver Wattle	5 %	Tubestock	6 x 3m
<i>Acacia melanoxylon</i>	Blackwood	40 %	Tubestock	1 x 4m
<i>Lepidospermum lanigerum</i>	Woolly Tea-tree	10 %	Tubestock	5 x 4m
<i>Melaleuca ericifolia</i>	Swamp Paperbark	10 %	Tubestock	6 x 4m
<i>Melaleuca squarrosa</i>	Scented Paperbark	10 %	Tubestock	5 x 3m

LARGE SHRUBS

<i>Hakea nodosa</i>	Yellow Hakea	10 %	Tubestock	3m ht
<i>Kunzea ericifolia</i>	Kunzea	5 %	Tubestock	1.8m ht

NOTE: All indigenous plants are to be of local provenance, supplied by a Local Indigenous Nursery.

PROPOSED BUFFER TREE PLANTING

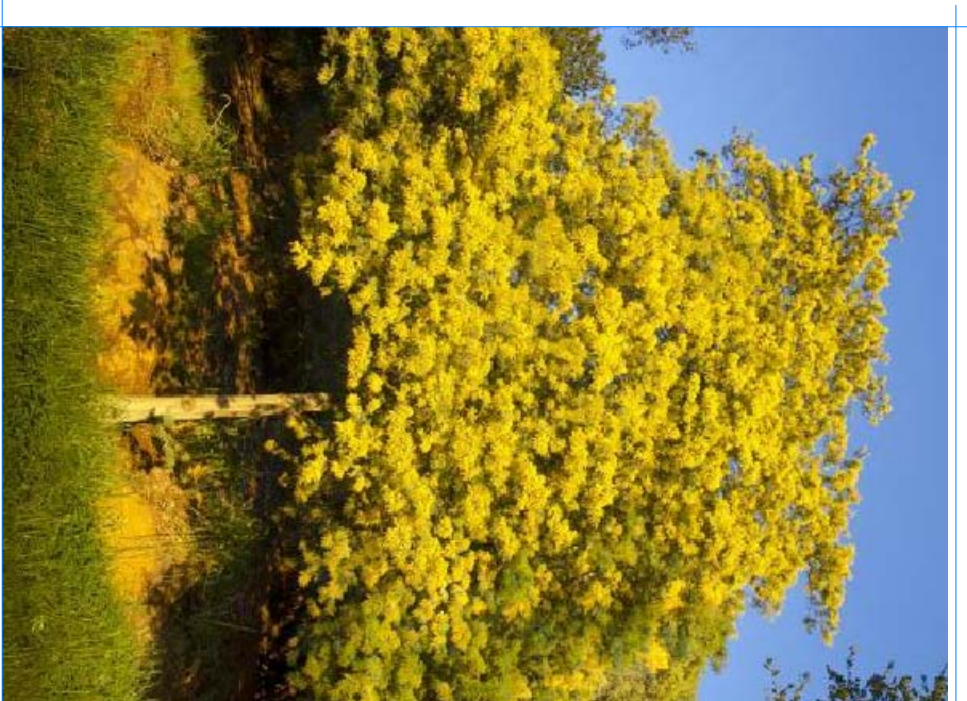

Acacia dealbata Silver Wattle

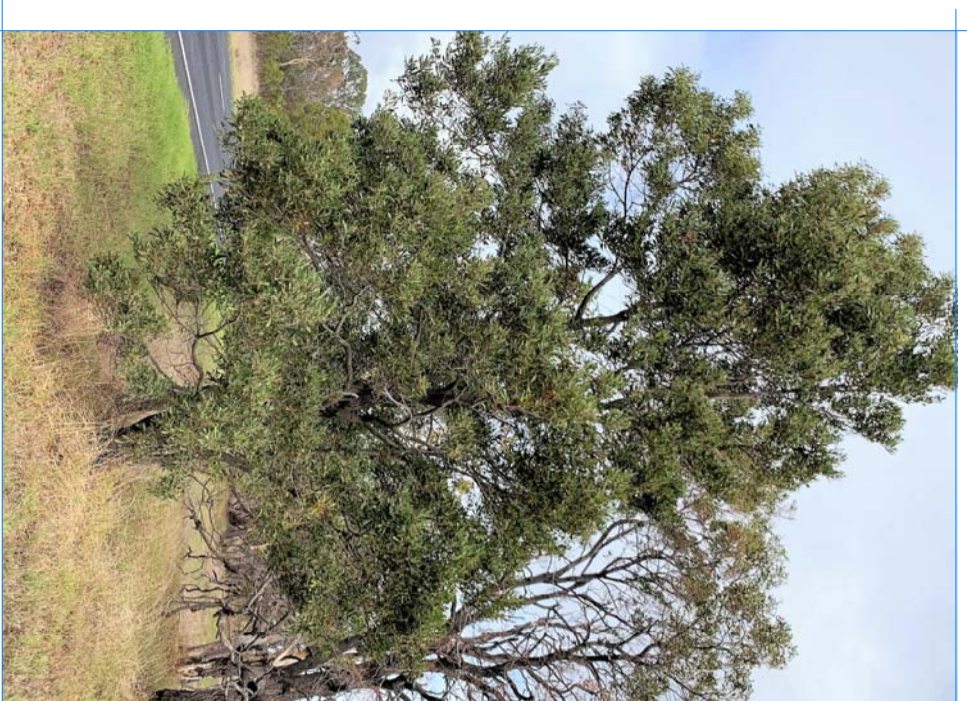

Acacia melanoxylon Blackwood



Lepidospermum lanigerum Woolly Tea-tree

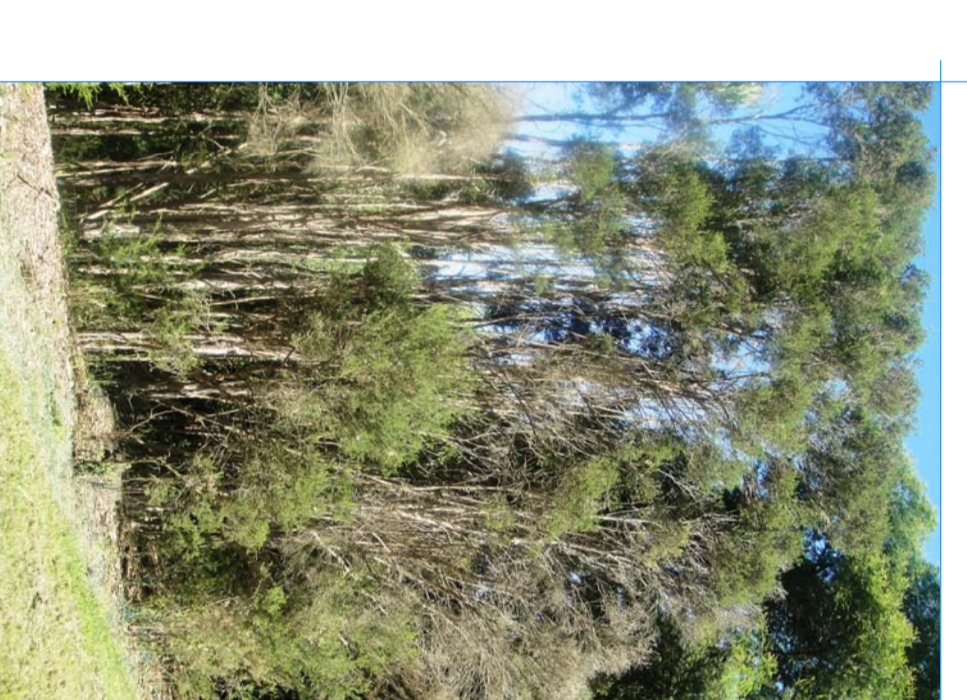

Melaleuca ericifolia Swamp Paperbark

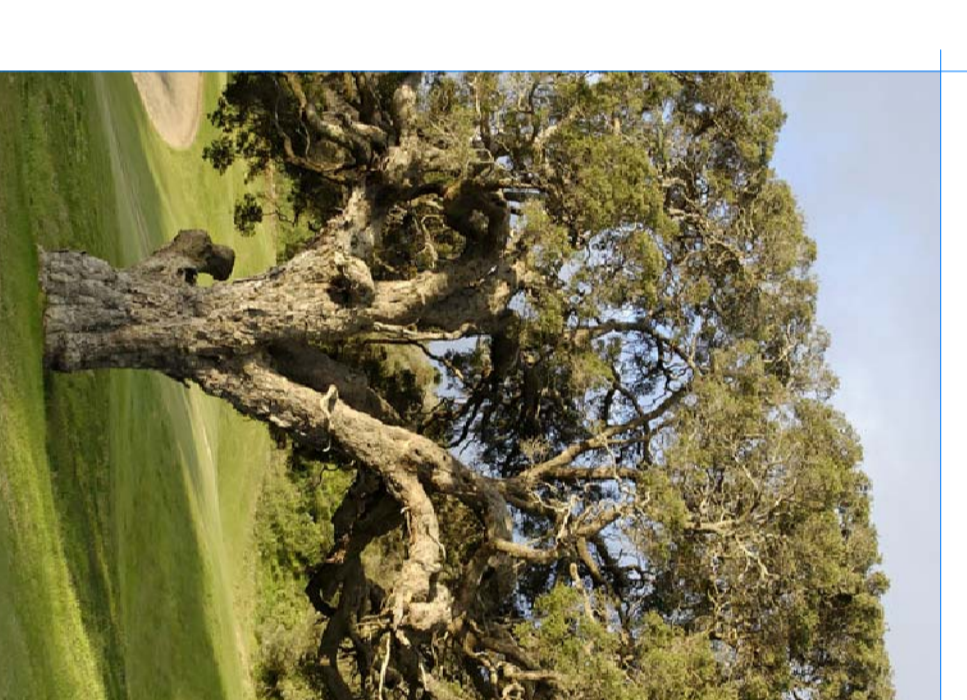

Melaleuca squarrosa Scented Paperbark

LARGE SHRUBS



Hakea nodosa Yellow Hakea



Kunzea ericifolia Kunzea

EXISTING TREES

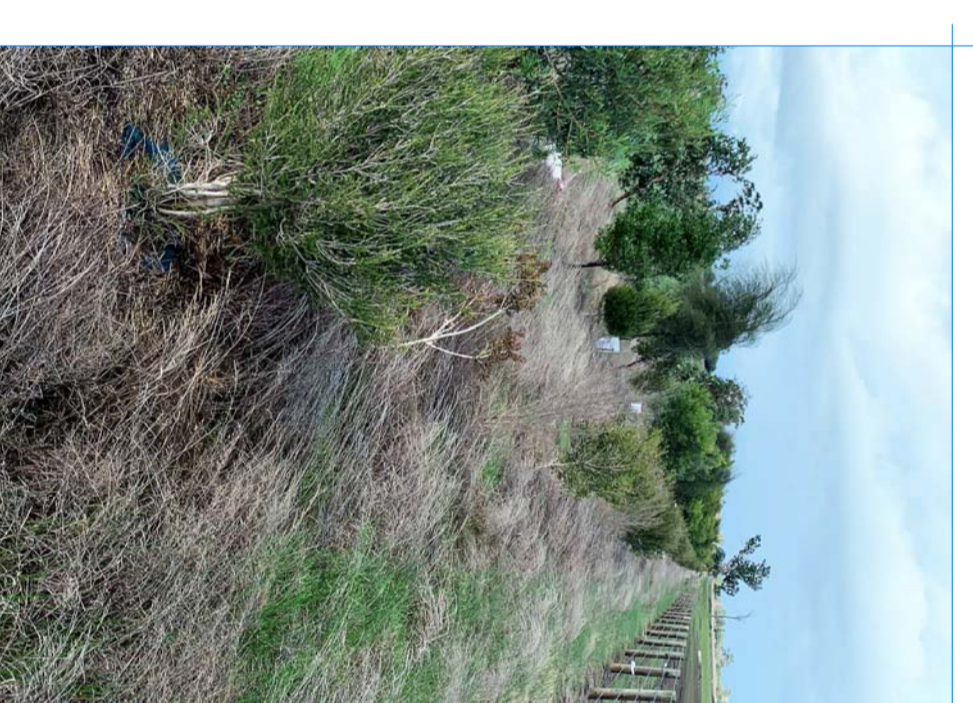

Existing Scented Paperbark

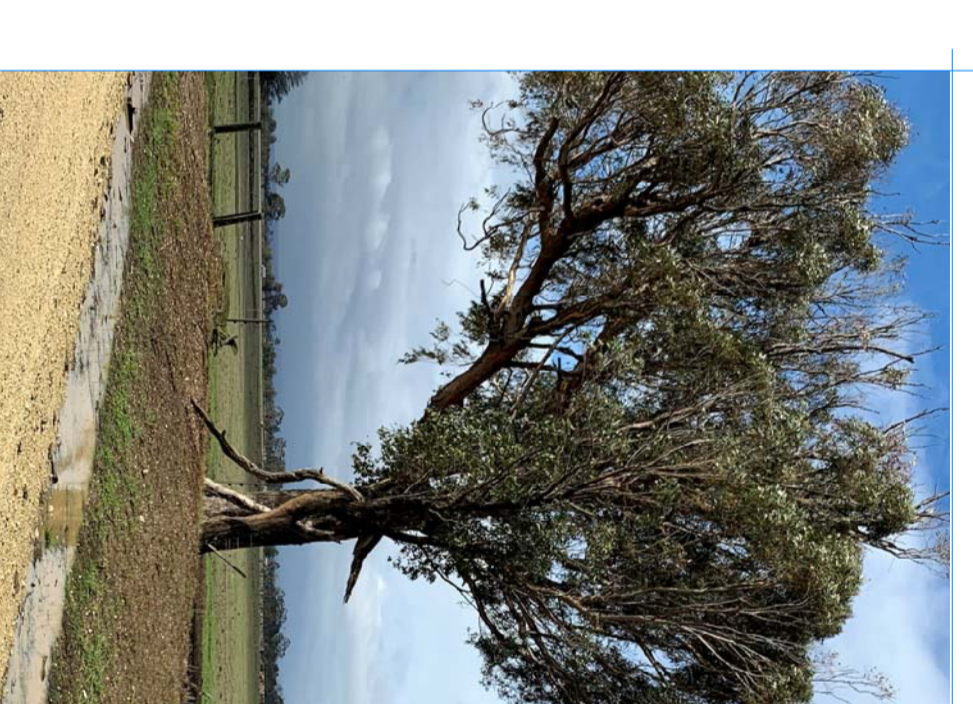

Existing River Red Gum
Eucalyptus camaldulensis

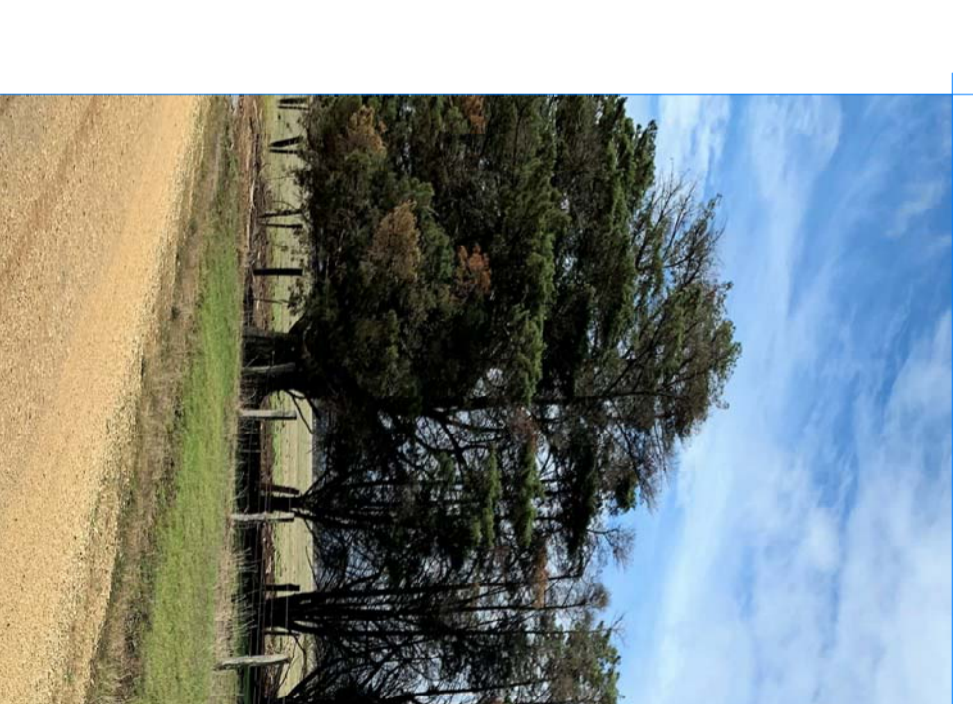

Existing Row of Cypress Pine
Cupressus macrocarpa



Existing Tree Copse *Acacia melanoxylon*
on Road Reserve

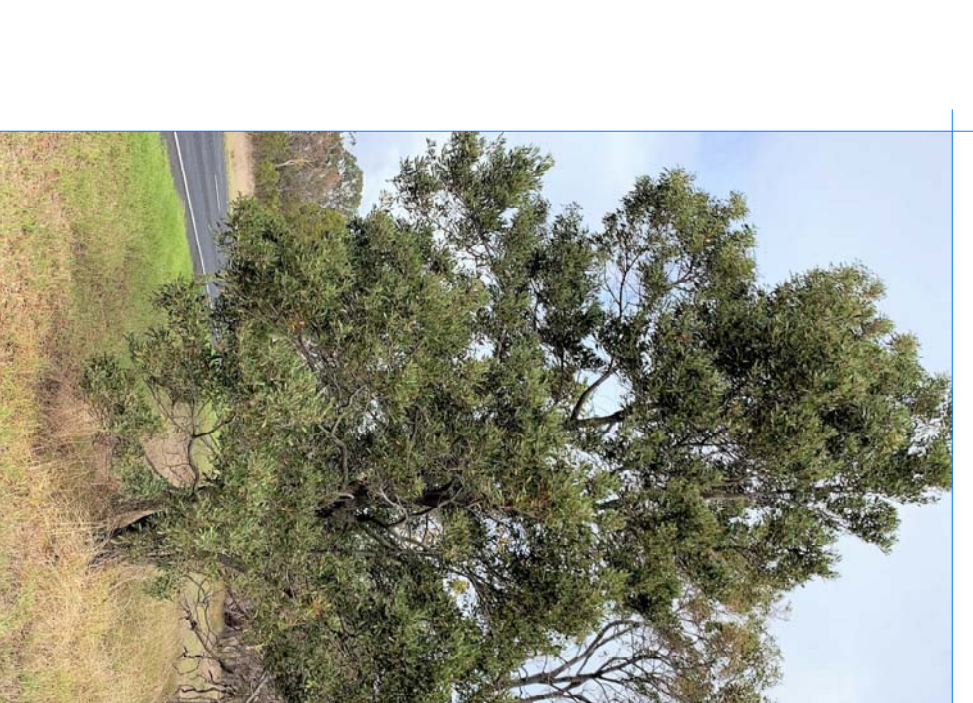

Existing *Acacia melanoxylon* Blackwood

REVISION
C PLANNING 1561E

DATE
OCT 2019

SCALE
DATE
OCT 2019
JOB NO.
1066

PROJECT
FRAGERS SOLAR FARM

DRAWING
PLANT SCHEDULE AND PLANT IMAGES

FORM
LANDSCAPE DESIGNERS

South Energy
Level 27
Melbourne VIC 3000
Ph: +61 (0)3 9842 8888
www.southenergy.com.au

entura
The power of natural thinking
89 Cambridge Park Drive,
Cambridge, Tasmania 7170 AUSTRALIA
Ph: 03 6245 4500 Fax: 03 6245 4550
www.entura.com.au

DRAWING NO.
LC 04

REV C