

ENTURA IS A BUSINESS OF HYDRO-ELECTRIC CORPORATION ABN 48 072 377 558

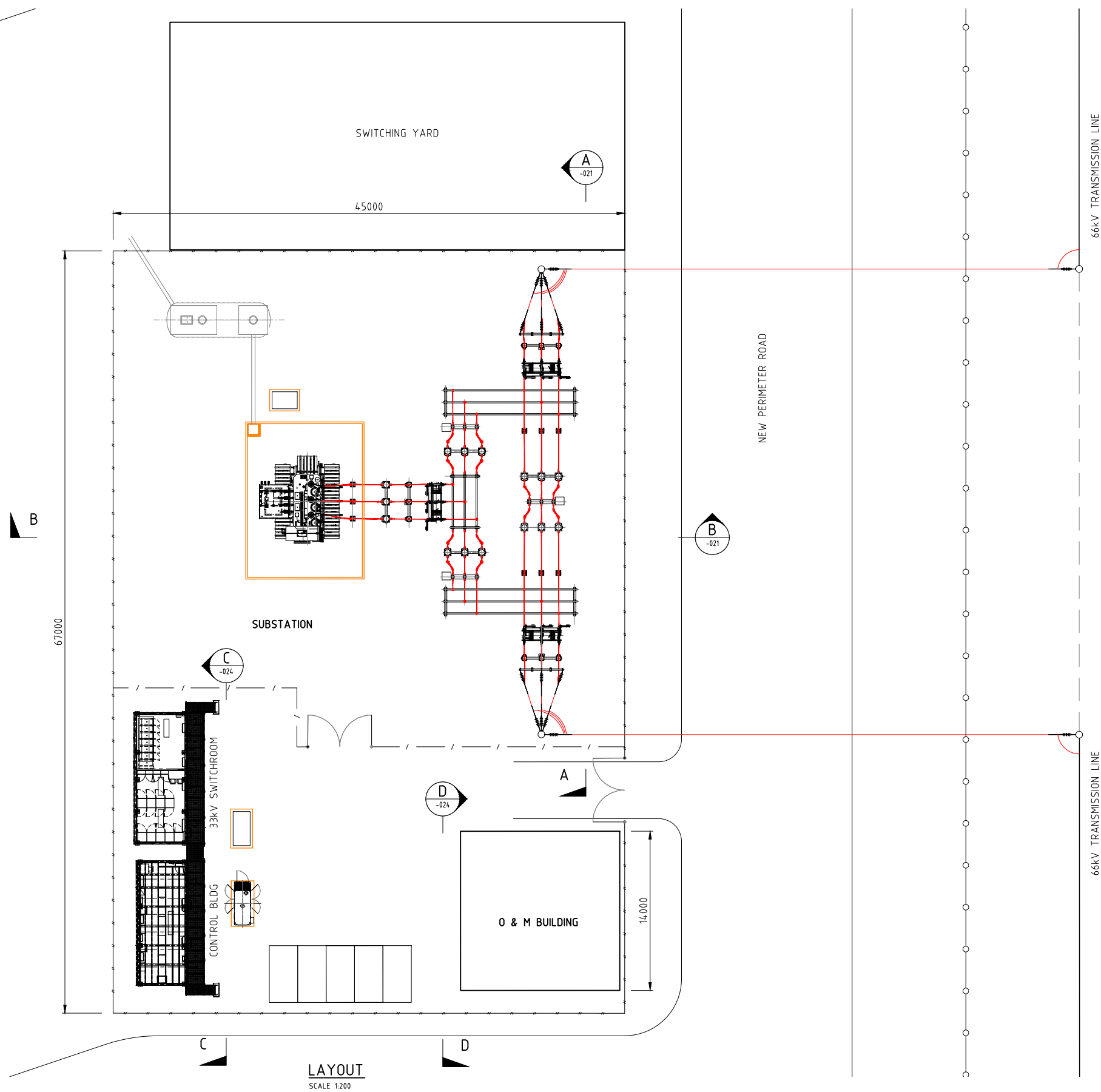

LAYOUT  
SCALE 1:200

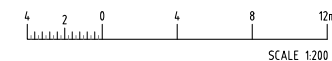

ALTERATIONS  
ORIGINAL ISSUE  
(P514660)

CLIENT  
**South Energy**  
South Energy  
Level 27, 150 Lonsdale Street,  
Melbourne VIC 3000  
Ph: +61 (03) 8842 6888  
www.southenergy.com.au

CONSULTANT  
**entura** | The power of natural thinking  
Hydro Tasmania  
89 Cambridge Park Drive,  
Cambridge, Tasmania, 7170, AUSTRALIA  
Ph: 03 6245 4500 Fax: 03 6245 4550  
www.entura.com.au  
© COPYRIGHT 2020

|              |     |
|--------------|-----|
| DRAWN        | GJS |
| CHECKED      |     |
| DESIGNED     |     |
| CHECKED      |     |
| APPROVED     |     |
| DATE         |     |
| CLIENT APP'D |     |
| DATE         |     |

|         |  |                |        |
|---------|--|----------------|--------|
| CLIENT: | SOUTH ENERGY   | ENGAGEMENT No: | 308127 |
| TITLE   | FRASERS SOLAR FARM<br>CONCEPTUAL<br>66 kV SUBSTATION<br>LAYOUT |                |        |
| SCALE   | 1:200  |                |        |
| SIZE    | A1   |                |        |
| REV.    | 1  |                |        |
| ORG No: | E308127 - 020  |                |        |